

BORU PUNTASI

- SERTLİK : HRC50°
- EŞ MERKEZLİLİK : 0.005mm
- DAİRESELLİK : 0.005mm
- MALZEME : ÇELİK

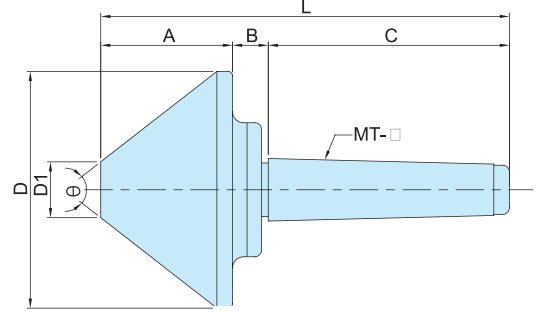

DETAYLAR

KOD	ÖLÇÜ	A	B	C	D	D1	L	MAX.HIZ R.P.M.	θ	100 RPMDE YÜK KAPASİTESİ (kg)	AĞIRLIK (kg) BÜRÜT	BİRİM mm
												FİYAT KODU
VLC-433	MK3x3"	52	18	86	78	15	156	3300	60°	400	1.6	15145
VLC-434	MK3x4"	59	16	86	106	25	161	3000	70°	400	2.8	15146
VLC-443	MK4x3"	52	18	108	78	15	178	3300	60°	400	1.8	15147
VLC-444	MK4x4"	59	16	108	106	25	183	3000	70°	500	3.1	15148
VLC-445	MK4x5"	73	12	108	128	40	193	2000	70°	650	4.9	15149

DETAYLAR

KOD	ÖLÇÜ	A	B	C	D	D1	L	MAX.HIZ R.P.M.	θ	100 RPMDE YÜK KAPASİTESİ (kg)	AĞIRLIK (kg) BÜRÜT	BİRİM mm
												FİYAT KODU
VLC-446	MK4x6"	88	12	108	156	45	208	1900	70°	800	7.7	15150
VLC-448	MK4x8"	98	12	108	206	81	218	1500	75°	1300	15.4	15151
VLC-455	MK5x5"	73	12	136	128	40	221	2000	70°	650	5.8	15152
VLC-456	MK5x6"	88	12	136	156	45	236	1900	70°	800	8.6	15153
VLC-458	MK5x8"	98	12	136	206	81	246	1500	75°	1600	15.7	15154

ELMAS UÇLU SABİT PUNTA

- ELMAS UÇ SERTLİĞİ HRC 70° SERTLEŞTİRİLMİŞ VE HASSAS TAŞLANMIŞTIR
- EŞMERKEZLİLİK= 0,002" (0,005mm) İÇİNDEDİR.
- DIN 806

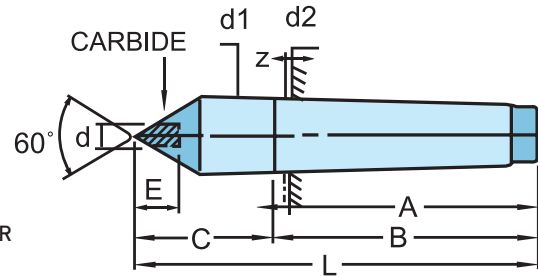

DETAYLAR

KOD	ÖLÇÜ	L	A	B	C	E	d2	d1	d	AĞIRLIK (kg)	BİRİM mm
											FİYAT KODU
VLC-112	MK-2	100	69	67	31	8	17.780	18.0	6	0.2	15155
VLC-113	MK-3	125	89	81	39	10	23.825	24.1	8	0.4	15156
VLC-114	MK-4	155	109	102.5	46	14	31.267	31.6	10	0.8	15157
VLC-115	MK-5	200	136	129.5	64	18	44.399	44.7	14	2.1	15158
VLC-116	MK-6	270	190	182	80	30	63.648	63.8	18	5.7	15159