

DÖNER PUNTALAR - CNC TORNALAR İÇİN

TİP 140

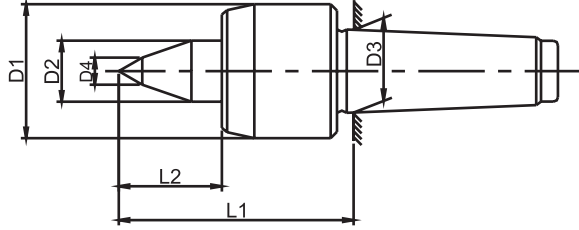

RULMAN ÖMRÜ 2000 İŞ SAATİDİR.

- PUNTA UCU SERTLİĞİ 60-62 HRc
- SALGI: MAX. 0,008 mm

SİP. NR.	KONİK	D1 (mm)	D2 (mm)	D3 (mm)	D4 (mm)	L1 (mm)	L2 (mm)	DEVİR d/d (max)	PARÇA AĞIRLIĞI KG (max)	FİYAT KODU
144	MK4	70	32	31.267	12	102	40	5000	500	00952
145	MK5	90	40	44.399	15	129	50	4000	850	00953

SABİT PUNTALAR - NORMAL UÇLU

TİP 400

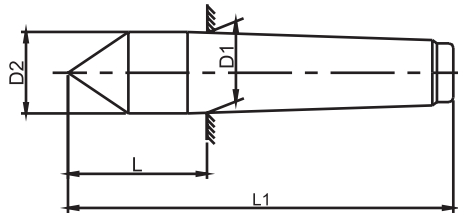

- KOMPLE SERTLEŞTİRİLİP TAŞLANMIŞTIR
- PUNTA UCU SERTLİĞİ 60-62 HRc
- SALGI: MAX. 0,005 mm

SİP. NR.	KONİK	D1 (mm)	D2 (mm)	L (mm)	L1 (mm)	FİYAT KODU
402	MK2	17.780	18	36	100	00954
403	MK3	23.825	24.1	44	125	00955
404	MK4	31.267	31.6	57.5	160	00956
405	MK5	44.399	44.7	70.5	200	00957
406	MK6	63.348	63.8	88	270	00958