

SK KOMBİNE MALAFALAR

DIN 69871

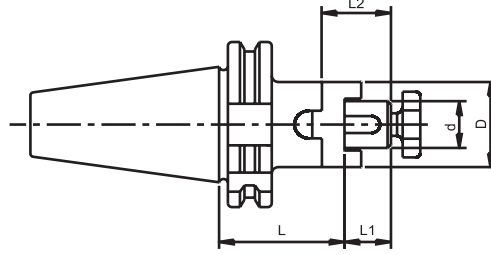

ALIN CİVATASI, TIRNAKLI PUL VE
KAMA İLE BİRLİKTE TESLİM EDİLİR.



DIN 6358

- MALZEME: 20 Mn Cr5
- SERTLİK: 58 ± 2 HRc
(Derinlik 0,6-0,9 mm)
- AÇI: DIN 7178-1/AT3
DIN 2080-1/AT3
- SALGI: MAX. 0,006 mm

• İÇTEN SU VERME SİSTEMİ OPSİYONELDİR. (SİPARİŞ ÜZERİNE ÜRETİLİR)

SİP. NR.	KONİK	d (mm)	D (mm)	L (mm)	L1 (mm)	L2 (mm)	FİYAT KODU
SK30.16.K	SK30	16	32	50	17	27	00677
SK30.22.K	SK30	22	40	50	19	31	00678
SK30.22.K-100	SK30	22	40	100	19	31	00679
SK30.27.K	SK30	27	48	55	21	33	00680
SK40.16.K	SK40	16	32	55	17	27	00681
SK40.16.K-100	SK40	16	32	100	17	27	00682
SK40.16.K-160	SK40	16	32	160	17	27	00683
SK40.22.K	SK40	22	40	55	19	31	00684
SK40.22.K-100	SK40	22	40	100	19	31	00685
SK40.22.K-160	SK40	22	40	160	19	31	00686
SK40.27.K	SK40	27	48	55	21	33	00687
SK40.27.K-100	SK40	27	48	100	21	33	00688
SK40.27.K-160	SK40	27	48	160	21	33	00689
SK40.32.K	SK40	32	58	60	24	38	00690
SK40.32.K-100	SK40	32	58	100	24	38	00691
SK40.32.K-160	SK40	32	58	160	24	38	00692
SK40.40.K	SK40	40	70	60	27	41	00693
SK40.40.K-100	SK40	40	70	100	27	41	00694
SK40.40.K-160	SK40	40	70	160	27	41	00695
SK50.16.K	SK50	16	32	55	17	27	00696
SK50.22.K	SK50	22	40	55	19	31	00697
SK50.27.K	SK50	27	48	55	21	33	00698
SK50.32.K	SK50	32	58	55	24	38	00699
SK50.40.K	SK50	40	70	55	27	41	00700
SK50.50.K	SK50	50	85	70	30	46	00701
SK50.60.K	SK50	60	98	70	50	66	00702