

ISO MANDREN MALAFALARI

DIN 2080

ISO 2583

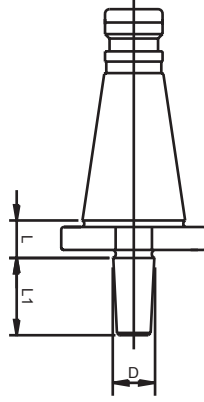

DIN 238

- MALZEME: 20 Mn Cr5
- SERTLİK: 58 ± 2 HRc (Derinlik 0,6-0,9 mm)
- AÇI: DIN 7178-1/AT3  
DIN 2080-1/AT3
- SALGI: MAX. 0,006 mm

SİP. NR.	KONİK	MANDREN KONİĞİ	D (mm)	L (mm)	L1 (mm)	FİYAT KODU
ISO40.B16	ISO 40	B16	15,733	17	24	00452
ISO40.B18	ISO 40	B18	17,780	17	32	00453

ISO MANDRENLİ BAŞLIKLAR

DIN 2080

ISO 2583

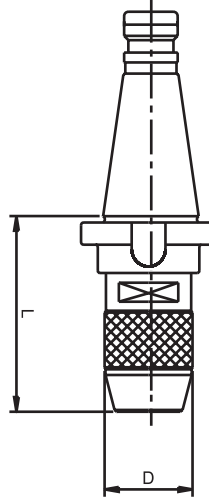

ELLE VE ANAHTARLA  
SİKILIP ÇÖZÜLEBİLİR.

- SALGI:MAX. 0,06 mm

SİP. NR.	KONİK	SIKMA KAPASİTESİ (mm)	D (mm)	L (mm)	FİYAT KODU
ISO40.1-13	ISO 40	1-13	42	80	00454
ISO40.1-16	ISO 40	1-16	49	100	00455