

## KEPENKLİ AYNA

TİP K72

## ÖZELLİKLER

- 4 AYAKLI HER BİR AYAK BAĞIMSIZ OLARAK AYARLANABİLİR
- KARE, ÇOKGEN, DAİRESEL OLAN VEYA OLMAYAN PARÇALARIN İŞLENMESİNDE KULLANILIR.
- UNIVERSAL TORNA TEZGAHLARINDA FENER MİLİNE FLANŞ İLE BAĞLANIR
- FREZELER, DİVİZÖRLER VE TABLALARDA KULLANILABİLİR

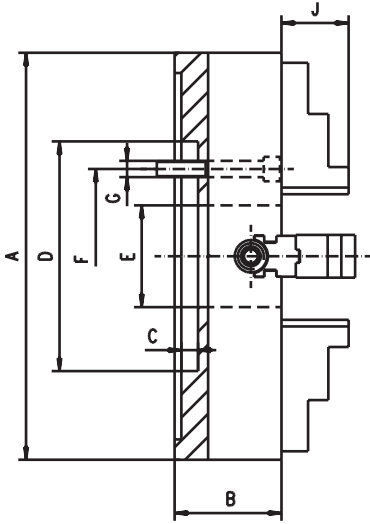

									BİRİM mm
KOD	CHARK.160	CHARK.200	CHARK.250	CHARK.320	CHARK.400	CHARK.500	CHARK.630	CHARK.800	CHARK.1000
ØA	160	200	250	320	400	500	630	800	1000
B	65	80	90	90	95	106	118	132	150
C	5	6	6	6	8	8	10	12	15
D H7	75	80	110	140	160	200	220	250	320
E	45	56	75	95	125	160	180	210	260
F	95	112	130	165	185	236	258	300	370
G	4XM10	4XM10	4XM12	4XM16	4XM16	4XM20	4XM20	8XM20	8XM120
J	24	27	30	44	48	55	62	70	80
<b>FİYAT KODU</b>	<b>14554</b>	<b>14555</b>	<b>14556</b>	<b>14557</b>	<b>14558</b>	<b>14559</b>	<b>14560</b>	<b>14561</b>	<b>14562</b>

STANDART AKSESUARLAR	1 TAKIM DÜZ AYAK	1 ADET ANAHTAR	FLANŞ BAĞLAMA CIVATASI