

Referans Nr.	Stopersiz Kullanım In Use Without Slip Stopper		Stoperli Kullanım In Use With Slip Stopper		 (kg)
	Sıkma Kuvveti Clamping Force Kgf	Tork Değeri Allowable Screw Torque (N-m)	Sıkma Kuvveti Clamping Force Kgf	Tork Değeri Allowable Screw Torque (N-m)	
2135-1260	2900	38	6900	90	2.4

M12 civata için 4 adet pul dahildir.  
4 washers for M12 bolts are included.

#### Ürün Nr. 2135 Yandan Bağlama

##### Gövde

- Malzeme: GGG60 DIN
- Siyah kaplama

##### Ön Çene

- Malzeme: Ck45 DIN
- Sertlik: 28-32 HRC

##### Siyah Kaplama

##### Civata

- Malzeme: 42CrMo 4 DIN
- Sertlik: İndüksiyon
- Siyah Kaplama

#### Product Nr. 2135 Side Clamps

##### Body

- Material: GGG60 DIN
- Black coating

##### Jaw

- Material: Ck45 DIN
- Hardness: 28-32 HRC
- Black coating

##### Bolt

- Material: 42CrMo 4 DIN
- Hardness: Induction
- Black coating

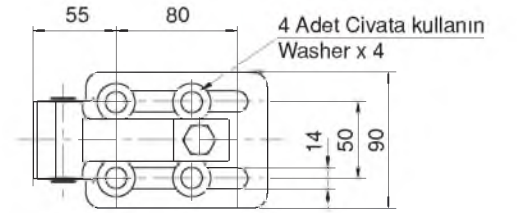
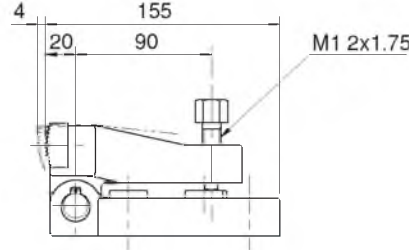
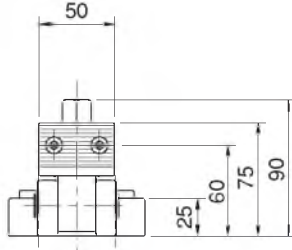

## Yandan Bağlama

### Side Clamps

Referans Nr.	Sıkma Kuvveti Clamping Force Kgf	Tork Değeri Allowable Screw Torque (N-m)	 (kg)
2137-16060	5800	150	2.9

M12 ve M16 vidalar için 2 adet dereceli pul dahildir.  
2 spherical washers for both M12 and M16 screws are included.

#### Ürün Nr. 2137 Yandan Bağlama

##### Gövde

- Malzeme: GGG60 DIN
- Siyah kaplama

##### Ön Çene

- Malzeme: Ck45 DIN
- Sertlik: 28-32 HRC

##### Siyah Kaplama

##### Civata

- Malzeme: 42CrMo 4 DIN
- Sertlik: İndüksiyon
- Siyah Kaplama

#### Product Nr. 2137 Side Clamps

##### Body

- Material: GGG60 DIN
- Black coating

##### Jaw

- Material: Ck45 DIN
- Hardness: 28-32 HRC
- Black coating

##### Bolt

- Material: 42CrMo 4 DIN
- Hardness: Induction
- Black coating

