

Referans Nr.	a	c	h	b	L	L1	L2	sw	d	Sıkma Kuvveti Clamping Force		
										f1 Kgf	f2 Kgf	
2110-12	12	3	20	40	80	39	26	6	M10	1600	60	415
2110-14	14									2200	90	425
2110-16	16									3200	120	785
2110-18	18	4	25	50	100	46	34	8	M14	3600	140	810
2110-20	20									3600	140	850
2110-22	22									3600	140	2275
2110-24	24	5	30	78	140	65	50	10	M20	3600	140	2360
2110-28	28									4000	160	2500

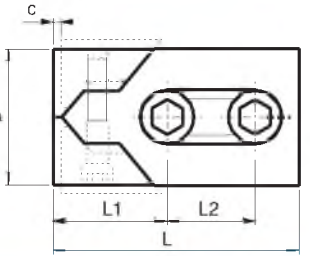

### Ürün Nr. 2110 Çift Çeneli Yandan Bağlama

- İş parçasını dayama ve pleyt yönünde sıkar, pabucun yapısından dolayı kuvvetli sıkma yapar.
- Sertlik 38 HRC
- Malzeme Ck45 DIN
- Siyah kaplama

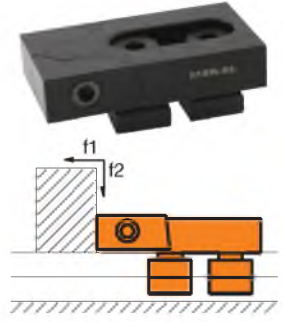
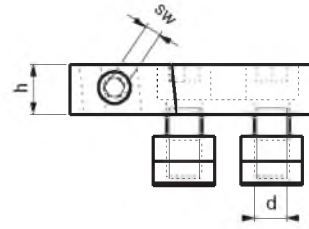

### Product Nr. 2110 Side Press Clamp with Double Claw

- Product clamps the work piece in the direction of rest and plate. It achieves powerful clamping because of the clamp's structure.
- Hardness: 38 HRC
- Material: Ck45 DIN
- Black coating

Referans Nr.	a	a h6	b -0.6	c DIN 650	d ±0.01	h1 ±0.01	h1 ±0.02	h2	h3	ISO 4762	
2120-1425	14	0-0.011	14	24	32	25	-	9	8	M8x35	200
2120-1450	14	0-0.011	14	24	32	-	50	9	8	M8x60	355
2120-1825	18	0-0.011	18	30	40	25	-	15	10	M10x50	360
2120-1850	18	0-0.011	18	30	40	-	50	15	10	M10x75	600
2120-2225	22	0-0.013	20	38	40	25	-	15	14	M10x55	410
2120-2250	22	0-0.013	20	38	40	-	50	15	14	M10x80	650

## Silindir Dayama Cylinder Pluggable



### Ürün Nr. 2120 Silindir Dayama

- Malzeme: 42 CrMo 4 DIN
- Sertlik: 38-40 HRC
- Siyah Kaplama

### Product Nr. 2120 Cylinder Pluggable

- Material: 42 CrMo 4 DIN
- Hardness: 38-40 HRC
- Black coating

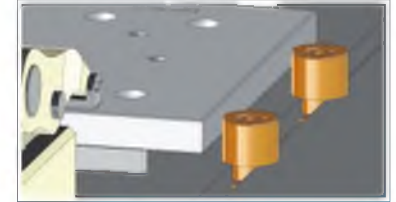
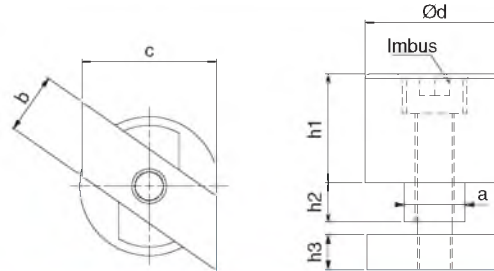

Referans Nr.	a	n	e	c	d	b	h	k	L	sw	
2130-12	12	11.7	18	18	M8	9	3	7	36	6	100
2130-14	14	13.7	22	22	M8	11	4	8	44	6	180
2130-16	16	15.7	25	25	M12	12.5	5	9	50	10	270
2130-18	18	17.7	28	28	M12	14	5	10	56	10	355
2130-20	20	19.7	32	32	M16	16	5	12	64	14	570
2130-22	22	21.7	35	35	M16	17.5	6	14	70	14	770
2130-24	24	23.7	40	40	M20	20	6	16	80	17	1180
2130-28	28	27.7	44	44	M20	22	6	18	88	17	1560

## Dayama Clamp Rest



### Ürün Nr. 2130 Dayama

- Dayama referans alma, uzunlamasına ve enlemesine kullanılır.
- Malzeme Ck45 DIN
- Sertlik 32 HRC
- Siyah kaplama

### Product Nr. 2130 Clamp Rest

- Clamp Rest is used for reference taking, longitudinal and cross-wise.
- Material: Ck45 DIN
- Hardness: 32 HRC
- Black coating

