

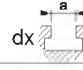
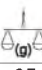
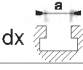

Referans Nr.		x L	b	a	e	k	
1610-1010040	M10x10	x40	23	9.7	15	6	65
1610-1010063		x63	45				80
1610-1010080		x80	50				90
1610-1010100		x100	60				110
1610-1012050	M10x12	x50	35	11.7	18	7	85
1610-1012063		x63	40				95
1610-1012080		x80	55				100
1610-1012100		x100	60				110
1610-1012125		x125	75				125
1610-1012160		x160	90				140
1610-1012200	x200	120	160				
1610-1212050	M12x12	x50	35	11.7	18	7	120
1610-1212063		x63	40				128
1610-1212080		x80	55				140
1610-1212100		x100	65				160
1610-1212125		x125	75				170
1610-1212160		x160	100				195
1610-1212200	x200	120	220				
1610-1214050	M12x14	x50	35	13.7	22	8	140
1610-1214063		x63	45				150
1610-1214080		x80	55				155
1610-1214100		x100	65				175
1610-1214125		x125	75				195
1610-1214160		x160	100				220
1610-1214200	x200	120	240				
1610-1416063	M14x16	x63	45	15.7	25	9	200
1610-1416080		x80	55				230
1610-1416100		x100	65				245
1610-1416125		x125	75				270
1610-1416160		x160	100				310
1610-1416200		x200	120				340
1610-1416250	x250	150	390				
1610-1616063	M16x16	x63	45	15.7	25	9	260
1610-1616080		x80	55				285
1610-1616100		x100	65				310
1610-1616125		x125	85				345
1610-1616160		x160	100				385
1610-1616200		x200	120				435
1610-1616250	x250	150	505				
1610-1618063	M16x18	x63	45	17.7	28	10	290
1610-1618080		x80	55				305
1610-1618100		x100	65				340
1610-1618125		x125	85				370
1610-1618160		x160	100				415
1610-1618200		x200	120				460
1610-1618250	x250	150	525				
1610-1820080	M18x20	x80	55	19.7	32	12	405
1610-1820100		x100	65				435
1610-1820125		x125	85				480
1610-1820160		x160	110				535
1610-1820200		x200	125				610
1610-1820250		x250	150				680
1610-1820315	x315	190	790				
1610-2020080	M20x20	x80	55	19.7	32	12	480
1610-2020100		x100	65				515
1610-2020125		x125	85				570
1610-2020160		x160	110				635
1610-2020200		x200	125				725
1610-2020250		x250	160				820
1610-2020315	x315	190	950				
1610-2022080	M20x22	x80	55	21.7	35	14	530
1610-2022100		x100	65				565
1610-2022125		x125	85				620
1610-2022160		x160	110				690
1610-2022200		x200	125				775
1610-2022250		x250	150				880
1610-2022315	x315	190	1050				
1610-2224080	M22x24	x80	55	23.7	40	16	700
1610-2224100		x100	65				740
1610-2224125		x125	85				805
1610-2224160		x160	110				890
1610-2224200		x200	125				1000
1610-2224250		x250	150				1115
1610-2224315	x315	190	1280				

Referans Nr.		x L	b	a	e	k	
1610-2424100	M24x24	x100	70	23.7	40	16	885
1610-2424125		x125	85				970
1610-2424160		x160	110				1060
1610-2424200		x200	125				1180
1610-2424250		x250	150				1320
1610-2424315		x315	190				1515
1610-2424400	x400	240	1750				
1610-2428100	M24x28	x100	70	27.7	44	18	1000
1610-2428125		x125	85				1065
1610-2428160		x160	110				1150
1610-2428200		x200	125				1280
1610-2428250		x250	150				1425
1610-2428315		x315	190				1640
1610-2428400	x400	240	1870				
1610-2428500	x500	290	2170				
1610-3036125	M30x36	x125	80	35.6	54	22	1900
1610-3036160		x160	110				2065
1610-3036200		x200	135				2250
1610-3036250		x250	150				2500
1610-3036315		x315	200				2770
1610-3036500		x500	300				3630
1610-3642160	M36x42	x160	100	41.6	65	26	3310
1610-3642250		x250	175				3930
1610-3642400		x400	250				5010
1610-3642600		x600	340				6900
1610-4248160	M42x48	x160	100	47.6	75	30	4600
1610-4248250		x250	175				5600
1610-4248400		x400	250				7200

DIN 787

Ürün Nr. 1610 Somunlu Pullu "T" Ayaklı Saplama

- Malzeme: 42 CrMo 4 DIN
- Kalite 12.9
- Siyah kaplama

Product Nr. 1610 T-Slot Bolt with Nut and Washer

- Material: 42 CrMo 4 DIN
- Quality 12.9
- Black coating

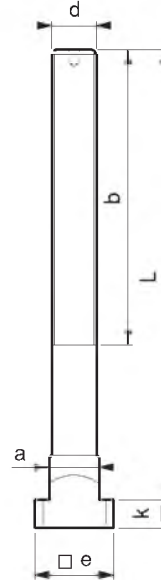

Not: 180 °C üzerindeki ısıya mukavim ortamdaki çalışmalarda firmamız ile irtibata geçiniz.

Note: Please contact with our company at work temperatures above 180 °C.