

Referans Nr.	L	b1	metrik		a	b2	a1xa2	e1	e2	h	 (g)
			metrik	whitworth							
1387-12070	70	13	M12	1/2	22	40	8x6	11	40	14	255
1387-16070	70	17	M16	5/8	30	40	10x7	11	40	22	290

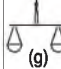

Ürün Nr. 1387 Plaka Sıkma Pabucu

- Yükselticisiz çalışma özelliği avantajı sağlar
- Malzeme: Ck45 DIN
- Sertlik: 32-35 HRC
- Siyah Kaplama

Product Nr. 1387 Plate Sliding Clamp

- Provides the advantage of working without support.
- Material: Ck45 DIN
- Hardness: 32-35 HRC
- Black coated

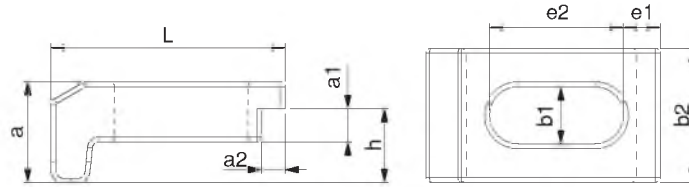

Kademeli Destek Delikli Çatal Pabuç

Bifurcated Clamp with Stepped Support Hole

Referans Nr.	L	b1	metrik		a	e2	a1xa2	b2	d	 (g)
			metrik	whitworth						
1400-10100	100	11	M10	3/8	20	70	10x10	30	M10	260
1400-12125	125	14.5	M12-14	1/2	25	90	12x12	40	M12	565
1400-16160	160	18.5	M16-18	5/8	30	110	15x16	50	M16	1235
1400-20200	200	22.5	M20-22	3/4	40	135	20x20	60	M20	2460



Ürün Nr. 1400 Kademeli Destek Delikli Çatal Pabuç

- Malzeme Ck45 DIN
- Sertlik 32-35 HRC
- Siyah Kaplama

Product Nr. 1400 Bifurcated Clamp with stepped support Hole

- Material: Ck45 DIN
- Hardness: 32-35 HRC
- Black Coating

Kademeli ve kısıtlı alanlarda kullanım avantajı sağlar.

It provides usage advantage in gradual and limited areas.

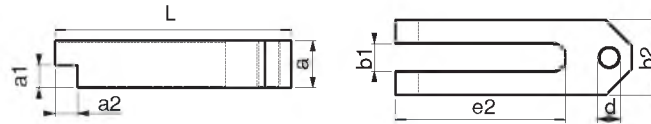

Destek Delikli Çatal Pabuç

Bifurcated Clamp with Support Hole

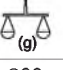
Referans Nr.	L	b1	metrik		a	e1	e2	b2	d	 (g)
			metrik	whitworth						
1410-10100	100	11	M10	3/8	20	5	70	30	M10	260
1410-12125	125	14.5	M12-14	1/2	25	6	90	40	M12	560
1410-16160	160	18.5	M16-18	5/8	30	8	110	50	M16	1230
1410-20200	200	22.5	M20-22	3/4	40	10	135	60	M20	1490



Ürün Nr. 1410 Destek Delikli Çatal Pabuç

- Malzeme Ck45 DIN
- Sertlik 32-35 HRC
- Siyah Kaplama

Product Nr. 1410 Bifurcated clamp with support hole

- Material: Ck45 DIN
- Hardness: 32-35 HRC
- Black Coating

Kademeli parçalarda ileri sıkmalarda hareket ve kullanım avantajı sağlar.

It provides usage advantage for gradual parts during forward tightenings.

