

| Referans Nr | b1 | a | DIN 787 | m | h | b x L | c | d | e1 | k | (g) |
|-------------|----|-------|------------|-----|------|--------|----|-----|----|----|------|
| 1210-013 | 13 | 12-14 | - | 52 | 0-40 | 40x90 | 28 | 48 | 23 | 14 | 340 |
| 1210-017 | 18 | 16-18 | - | 80 | 0-60 | 58x130 | 38 | 74 | 29 | 18 | 990 |
| 1210-021 | 22 | 20-22 | - | 98 | 0-75 | 68x140 | 46 | 80 | 32 | 20 | 1450 |
| 1210-025 | 26 | 24-28 | - | 110 | 0-90 | 78x175 | 52 | 100 | 39 | 24 | 2360 |
| 1210-012 | 13 | 12 | M12x12x100 | 52 | 0-40 | 40x90 | 28 | 48 | 23 | 14 | 400 |
| 1210-014 | 13 | 14 | M12x14x100 | 52 | 0-40 | 40x90 | 28 | 48 | 23 | 14 | 420 |
| 1210-016 | 18 | 16 | M16x16x160 | 80 | 0-60 | 58x130 | 38 | 74 | 29 | 18 | 1140 |
| 1210-018 | 18 | 18 | M16x18x160 | 80 | 0-60 | 58x130 | 38 | 74 | 29 | 18 | 1145 |
| 1210-020 | 22 | 20 | M20x20x200 | 98 | 0-75 | 68x140 | 46 | 80 | 32 | 20 | 1560 |



Ürün Nr. 1210 Kademeli Bağlama Pabucu

- Destek kullanmadan 0-75mm arası kullanım imkanı sağlar
- Malzeme: Ck45 DIN Dövme Çelik
- Sertlik: 35-38 HRC
- Siyah kaplama

Product Nr. 1210 Stepped Coupling Clamp

- It provides using between 0-75 mm without supporting.
- Material: Ck45 DIN Forged Steel
- Hardness: 35-38 HRC
- Black coated

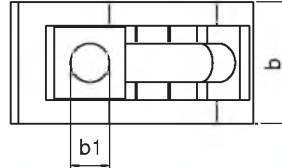
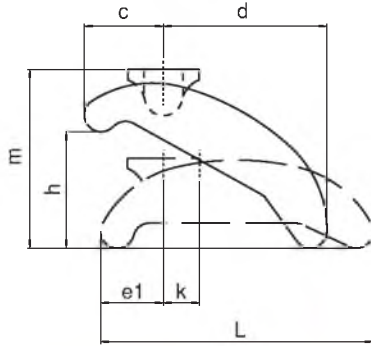

| Referans Nr. | a | h min - max | f | c | L | b | (g) |
|--------------|----------------|-------------|----|----|-----|----|------|
| 1230-01 | 14-16-18-20-22 | 40 - 80 | 5 | 16 | 110 | 38 | 1200 |
| 1230-02 | | 70 - 125 | 10 | 16 | 110 | 38 | 1490 |
| 1230-03 | | 120 - 175 | 10 | 18 | 110 | 38 | 2700 |
| 1230-04 | | 170 - 225 | 10 | 23 | 110 | 38 | 4260 |

Ürün Nr. 1230 Basamaklı Kombine Pabuç

- Pabucun çift taraflı kullanım özelliği; basamaklı yükselticisi ile kısıtlı alanlarda kullanım avantajı sağlar.
- DIN 650 "T" kanala uyumludur.
- Gövde malzeme GGG 60 DIN
- Pabuç malzeme Ck45 DIN Sertlik 32-35 HRC
- Civata 10.9 kalite
- Gövde statik boyalı diğer parçalar siyah kaplama

Product Nr. 1230 Stepped Combined Clamp

- Double-sided usage of the clamp provides using advantage in restricted areas
- Product is suitable to DIN 650 "T" Slot
- Body Material: GGG 60 DIN
- Clamp Material: Ck45 DIN and Hardness: 32-35 HRC
- Bolt Quality: 10.9
- Body is statically painted and the other parts are black coated

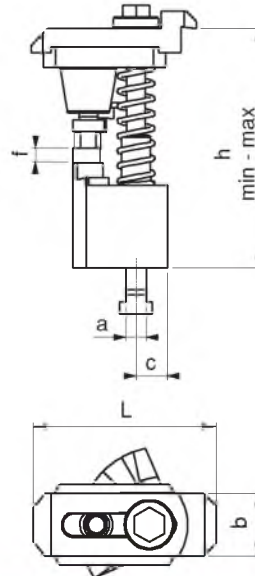

Basamaklı Kombine Pabuç

Stepped Combined Clamp

